



integral Seat Ring

Basic design complied with ANSI B16.34/ API 603

Flange end complied with ASME/ANSI B16.5

Face-to-face dimensions complied with ASME/ANSI B16.10

Valve testing & inspection: ANSI B16.34/API 598

Max Working Pressure: 285 PSI

Applicable Temperature: -29-120 °C

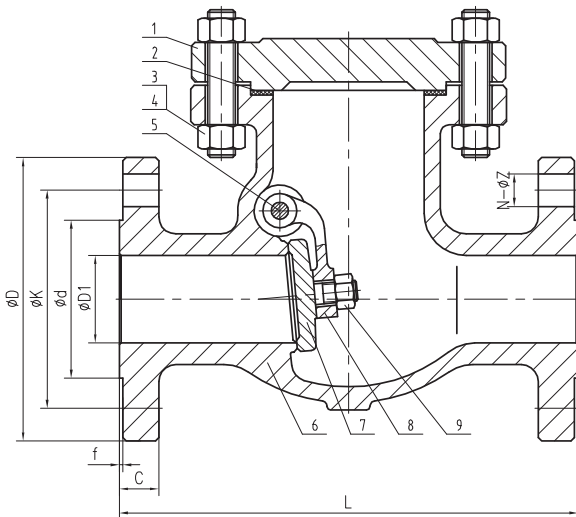

### Main Part Material

No	Part Name	MATERIAL			
		CF8	CF8M	CF3	CF3M
1	Bonnet	CF8	CF8M	CF3	CF3M
2	Gasket	PTFE			
3	Nut	SS304			
4	Stud	SS304			
5	Pin	SS304			
6	Body	CF8	CF8M	CF3	CF3M
7	Disc	SS304	SS316	SS304L	SS316L
8	Hinge	SS304	SS316	SS304L	SS316L
9	Nut	SS304			
10	Seal	PTFE			
11	Bolt	SS304			

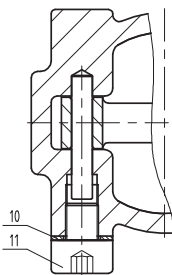

### Dimensions(mm)

NPS	$\phi D1$	$\phi D$	$\phi K$	$\phi D$	f	C	N- $\phi Z$	L
2"	50	92.1	120.7	150	2	16.3	4-19	203
2 1/2"	65	104.8	139.7	180	2	17.9	4-19	216
3"	80	127	152.4	190	2	19.5	4-19	241
4"	100	157.2	190.5	230	2	24.3	8-19	292
6"	150	215.9	241.3	280	2	25.9	8-22	356
8"	200	269.9	298.5	345	2	29	8-22	495
10"	250	323.8	362	405	2	30.6	12-25	622
12"	300	381	431.8	485	2	32.2	12-25	698